

Mono Universal Parts



Mono[®] **NOV**

One Company, Unlimited Solutions





Mono is a leading name in the design, manufacture and supply of progressing cavity pumps, parts, grinders, screens and packaged solutions, worldwide. We have 8 international sites and a global distribution network, as well as 75 years' experience in providing a range of products for the multiple application requirements of today's industries.



Mono Universal Parts

Mono has a reputation for quality in both equipment and parts. Over recent years it has been our mission to use our manufacturing and engineering expertise to expand our product offering to include high quality parts for other brands of progressing cavity (PC) pumps.

As such, all Mono Universal Parts attract the same warranties and guarantees as parts for Mono pumps.

Availability

Comprehensive stocks are held at Mono's head office and at our UK and international distributor locations. This offers best in class lead times, minimal downtime and eliminates the need for you to hold extensive stocks.

Same day delivery is available on request for stock items, to ensure minimum disruption and production stoppages. This industry leading service combined with competitive pricing gives you a trusted and valued source when buying your spare parts.

Mono Universal Parts can be purchased online via our e-commerce system. This service also allows you to check stock levels and lead times. Please visit www.mono-orders.com to register.

Competitive Pricing

With an increasing focus on operational and maintenance cost control, we understand that the price and availability of spare parts is high on the agenda when evaluating plant savings and efficiencies.

Using our global manufacturing facilities and leveraging our engineering know-how, we are able to produce Mono Universal Parts at highly competitive prices. Typically we can offer customers a saving of up to 40%.

Quality Assurance

We are in a unique position to closely control the quality and integrity of our parts as we manufacture all the key components of a PC pump in-house. Mono was the first progressing cavity pump manufacturer to be certified to ISO9001 and once again the first to achieve the upgrade Quality Management System to ISO9001:2000.

We are also certified to ISO14001, demonstrating our commitment to improving our environmental performance.



Product Portfolio

Please see below the most common ranges we cover, usually from stock. For others not listed, please contact Mono.

	seepex®	Netzsch®	PCM	Allweiler	Robbins & Myers	Bornemann	Orbit
PUMP RANGES	BN NS BT MD	NEMO® NM® NE® NU	I and ID IVA and IDVA MR/MV-I and ID	TECFLOW AE SN SH SZ	2000 Series 1000 Series L Frame	E Range	C Range A and B Range D and E Range
GEOMETRY	Std (standard) -L (long pitch) -T (2/3)	S (standard) L (long pitch) P (2/3 long)		Std (standard) TECFLOW (2/3)			

We can supply:

- Rotors
- Stators
- Coupling rods
- Shafts
- Pins/bushes
- Seals
- Drive train assemblies

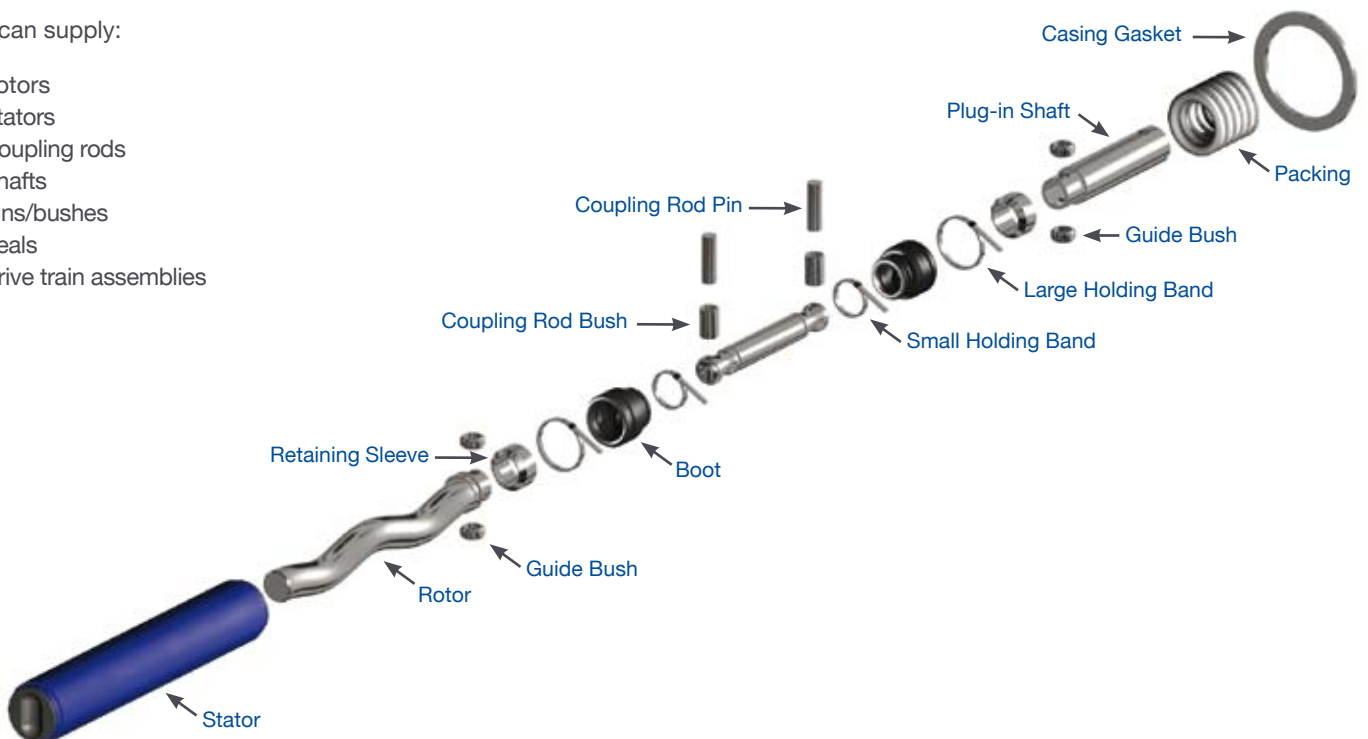

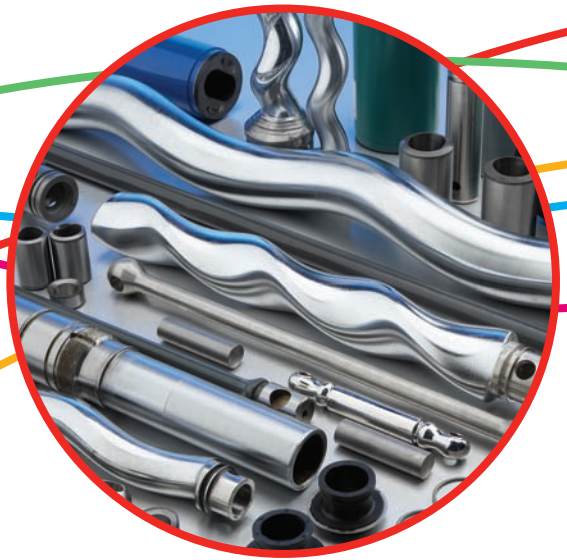

Rotating Assembly

On selected ranges, we can offer our customers fully assembled rotating units. This value adding service assists you in reducing your operational expenditure as it reduces assembly and installation time on site and gives cost savings by purchasing the complete unit rather than the individual components.

The following items are all included in the rotating unit:

- Rotor
- Stator
- Joint kit
- Coupling rod
- Plug in shaft
- Mechanical seal or gland packing

Please contact the Mono Universal Parts team to find out more.

Pump Replacement

Often the cost of replacing spare parts from other PC pump manufacturers can be extremely expensive. In some instances you can purchase a Mono progressing cavity pump for the same price or even less than the price of spares from your supplier.

We have developed our Chroma range of pumps that are directly interchangeable with the seepex BN and PCM I series. The Chroma is supported by Mono's industry leading aftermarket service and support. We have an ongoing programme of new product development, therefore if you have a requirement for a product range or size not listed here, please contact us to find out more about our innovation pipeline.

Service and Support

Our team of experienced application and sales engineers have a wealth of industry and product knowledge to assist you in correct product selection, problem solving and aftermarket support.

We have a dedicated aftermarket team to help you select the correct parts when carrying out routine maintenance and in the event of an unexpected breakdown, parts can be despatched the same day. Recommended parts lists are also available to assist with budgets and stock control.

Our promise is clear ... one company, unlimited solutions.

Contact the Mono Universal Parts team on:

T. +44 (0)161 214 2362/2363

F. +44 (0)161 214 2129

E. universalparts@nov.com



The Facts

Mono Universal Parts

1. Mono Universal Parts attract a three year warranty against defective materials and manufacture.

2. Mono will adopt the balance of asset warranty when Mono Universal Parts are fitted.*

3. All Mono Universal Parts are manufactured to ISO9001:2000.

4. Rotors are plated to a thickness of 0.25mm hard chrome plating as standard.

5. Stators are produced from fine tolerance tubing and custom developed elastomers to produce a long lasting quality second to none. Mono has developed its stator manufacturing process and elastomer compounds over 50 years of R&D, providing class leading wear characteristics and durability.

6. Multiple matrix testing has been conducted to ensure that Mono Universal Parts meet or exceed the performance of the original equipment manufacturer.

7. CE marking remains unaffected. Legislation states that if the intended function of the equipment is not changed significantly or modified in a way that would increase or change the risk of compromising the safety of personnel, the regulations are still met. Mono Universal Parts in no way fall into this category and as such do not affect the original declaration made by the OEM.

8. Compliance of ATEX approval is maintained. There is nothing in the statutory instruments relating to Supply of Machinery Regulations or ATEX that precludes the use of non-OEM spare parts. In fact, if this was the case it would be regarded as restrictive trade and anti-competitive, illegal under British and European law.

9. Mono holds millions of pounds worth of inventory at our Manchester plant, enabling us to operate 'Best in Class' lead times.

10. Mono operates a manned 24/7 emergency spares call out service.

*Subject to duty and application confirmation.



Europe

Mono Pumps Ltd, Martin Street, Audenshaw
Manchester, M34 5JA, England
T. +44 (0)161 339 9000
E. info@mono-pumps.com

D.M.I EST, 56, rue du Pont
88300 Rebeuville, France
T. +33 (0)3 29 94 26 88
E. dmi-est@dmi-est.fr

Americas

Monoflo NOV, 9700 West Gulf Bank
Houston, Texas 77040, USA
T. +1 281 272 7700
E. inquire@monoflo.com

Monoflo S.A., Ing Huergo 2239
(1842) Monte Grande
Pcia. de Buenos Aires, Argentina
T. +54 11 4290 9940/50
E. info@monoflo.com.ar

Monoflo Canada, 6010 - 53rd Ave
Alberta, Lloydminster
T9V2T2, Canada
T. +1 780 875 5584
E. info.monoflo@nov.com

Australasia

Mono Pumps (Australia) Pty Ltd
Mono House, 338-348 Lower Dandenong Road
Mordialloc, Victoria 3195, Australia
T. 1800 333 138
E. ozsales@mono-pumps.com

Mono Pumps (New Zealand) Ltd
PO Box 71-021, Fremlin Place, Avondale
Auckland 7, New Zealand
T. +64 (0)9 829 0333
E. info@mono-pumps.co.nz

Asia

Mono Pumps Ltd, No. 500 YaGang Road
Lujia Village, Malu, Jiading District
Shanghai 201801, P.R. China
T. +86 (0)21 5915 7168
E. monoshanghai@nov.com

www.mono-pumps.com

Published information other than that marked CERTIFIED does not extend any warranty or representation, expressed or implied, regarding these products. Any such warranties or other terms and conditions of sales and products shall be in accordance with Mono Pumps Limited standard terms and conditions of sale, available on request.

© Mono Pumps Limited May 2008 Literature reference: MPSB/07/01/R1

Mono® is a registered trademark of Mono Pumps Ltd. seepex® is a registered trademark of Seeberger GmbH + Co. NETZSCH®, NEMO®, NM® and NE® are registered trademarks of NETZSCH Mohnpumpen GmbH. Mono Pumps is not an authorised distributor of parts and services for the products of Seeberger GmbH, Allweiler, NETZSCH Mohnpumpen GmbH, PCM, Robbins & Myers, Bornemann and Orbit and Mono Pumps products are not associated with, endorsed by, or sponsored by these companies.
Registered in England No 300721

